

ORFS 90°, Überwurfmutter LORF 90°

ORFS 90°, WITH UNION NUT LORF 90°

PRESSNIPPEL
SWAGE FITTINGS

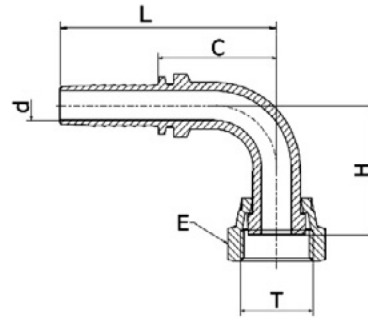

Technische Daten

ORFS-Dichtform mit Überwurfmutter, UN-/UNF-/UNS-Gewinde

Material:
Automatenstahl
Oberfläche:
Grill

Technical data

ORFS sealing form, with union nut, UN/UNF/UNS-Thread

Material:
Free cutting steel
Surface:
Grill

DN Nominal width	Size Size	Zoll Inch	Anschluss T Thread T	Abzugsmaß C (mm) Cut-off C (mm)	d (mm) d (mm)	E (mm) E (mm)	H (mm) H (mm)	L (mm) L (mm)	VE PU	Artikelnummer Article number
6	04	1/4	9/16-18	23,5	4,0	17	24,0	51,0	5	VC04LORF90S04
6	04	1/4	11/16-16	26,0	4,0	22	26,0	51,0	5	VC06LORF90S04
10	06	3/8	11/16-16	31,0	7,0	22	30,0	60,5	5	VC06LORF90S06
10	06	3/8	13/16-16	34,0	7,0	24	31,0	63,5	5	VC08LORF90S06
12	08	1/2	13/16-16	40,0	9,5	24	37,0	71,5	5	VC08LORF90S08
16	10	5/8	1-14	45,0	12,0	30	42,0	79,5	5	VC10LORF90S10
19	12	3/4	1.3/16-12	57,0	15,0	36	47,0	106,5	5	VC12LORF90S12
25	16	1	1.7/16-12	72,0	20,0	41	58,0	125,5	1	VC16LORF90S16

Standardnennweiten in **Fettdruck**, standard dimensions in **bold print**